

HOW TO INSTALL ROMAN SHADES

Before you begin installing your roman shades carefully unpack your shades and all mounting hardware. Familiarize yourself with the contents of the box and ensure all installation hardware is included.

Tools you will need:

- Steel measuring tape
- Pencil
- Level tool
- Step ladder (if necessary)
- Screwdriver or power drill (with ¼" hex driver and drill bit)



INSIDE MOUNT HARDWARE OUTSIDE MOUNT HARDWARE

INSIDE MOUNT ROMAN SHADES

If you measured for inside mount shades, follow these simple installation steps:

1. You'll find metal squares on top of the headrail, measure the separation between each one of them taking as a reference the center of the square.
2. According to the measurements you took in step 1, use a pencil to mark them on your window frame and screw the brackets into place with the narrow side facing you. Each bracket has a spring system that contracts to enter the rail; therefore, all brackets must be facing the same direction.
3. Mount your shade under the installed brackets, starting with the side facing towards you and push the rail towards the window and press upwards, you will feel the rail entering the spring. Make sure it's secured before you let go.



OUTSIDE MOUNT ROMAN SHADES

If you measured for outside mount shades, follow these simple installation steps:

1. You'll find metal squares on top of the headrail, measure the separation between each one of them taking as a reference the center of the square.
2. According to the measurements you took in step 1, use a pencil to mark them on your wall and screw the brackets into place. Each bracket has a spring system that contracts to enter the rail; therefore, all brackets must be facing the same direction. It's important that all brackets align for the shade to be properly installed.
3. Mount your shade under the installed brackets, starting with the side facing towards you and push the rail towards the window and press upwards, you will feel the rail entering the spring. Make sure it's secured before you let go.



JCHR35W3A1/2/3/4

Remote Controller

User Manual

02 Buttons

a.Front

01 Product Info

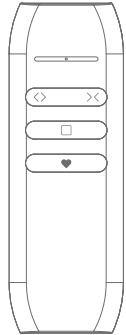

JCHR35W3A1

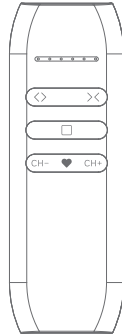

JCHR35W3A2

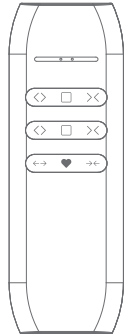

JCHR35W3A3

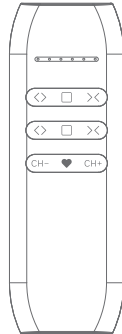

JCHR35W3A4

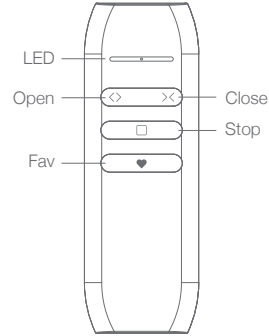

JCHR35W3A1
Single channel remote controller

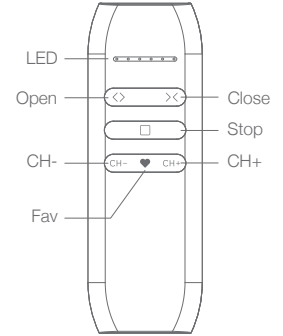

JCHR35W3A2
6-channel remote controller

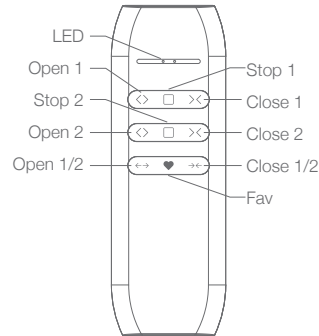

JCHR35W3A3
Single channel dual control remote controller

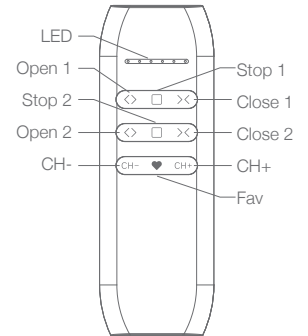

JCHR35W3A4
6-channel dual control remote controller

b.Back

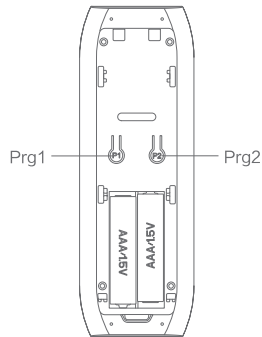

03 Parameters (more info please refer to the nameplate)

Electrical Specification	Standard
Battery Type	AAA battery*2
Working Temperature	-10°C-50°C
Radio Frequency	433.92M±100KHz
Transmit Distance	>=30m indoor

04 Caution!



- 1.The transmitter should not be exposed to moisture or impact, so as not to affect its life
- 2.During use, when the remote control distance is significantly shorter or less sensitive, please check whether the battery needs to be replaced.
- 3.When the battery voltage is too low, orange LED flickers when you press button, indicating to replace battery.
- 4.Pls properly dispose of used batteries according to the local garbage classification and recycling policy.

05 Instruction

a. Prohibit Dual-key Operation



Note: When dual-key operation prohibited, these programming setting functions are not allowed, such as limits setting.

b. Number of Channels Setting (Only apply to JCHR35W2A2、JCHR35WA4)

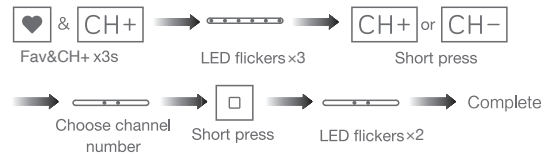

Note: When all LEDs are lit, that is channel 0 (All channels move together).

c. For other operations, pls refer to the motor user manual

Tubular Motor with Built-in Li-ion Battery (USB Charging) User Manual

01 Product Info

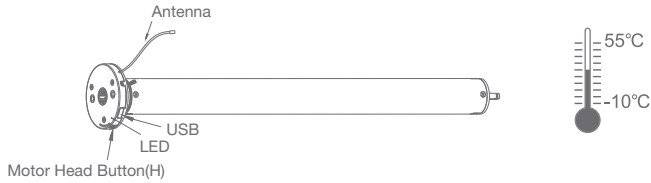

Remote Controller Buttons

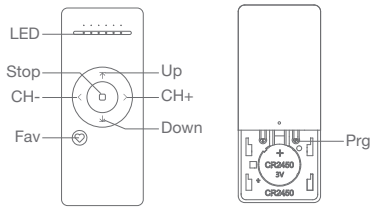

Power Options



Models & Parameters (for details about other parameters, see the product nameplate)

JCD	25	S	LE	U	11	30
DC Motor	Tube Diameter: 25mm	S: Standard Q: Quiet P: Performance	LE: With built-in Li-ion battery	USB Port	Torque: 1.1 N.m	Speed: 30 rpm

02 Caution!



- This product is for indoor use only, do not use outdoor or in humid environments.
- This motor has a built-in rechargeable Li-ion battery pack with integrated charge management. Max input voltage: 5V/2A.
- Please charge it before using for the first time, make sure it is fully charged before first use.
- When the battery voltage is low, LED will flicker 8 times to give a low-voltage alarm when motor starts.
- The motor will jog in operation, please do not proceed to the next step until it complete.
- During operation, the effective interval of the transmitter button operation is 10 seconds. If there is no effective transmitter operation for more than 10 seconds, it will automatically exit the current mode.
- The motor can be paired with max 10 controllers.
- Please do not use motor when charging.
- Upper&Lower limits cannot be set at the same position, limits saved even power off.
- The motor runs constantly for at 6 mins max without any other operation.
- Do not lift the motor by grabbing the wire or antenna.

03 Instructions

Motor head button (H) functions

Functions	Operation	Jogging time	LED lamp flickers	Note
Control the UP/STOP/DOWN of the Shade	Short press	/	/	Can only operate after the limits are set and motor is not in sleep mode
Adding/Removing Controller	Hold for 2s	Jog*1	Flicker*1	Operation needs be done within 10s
Sleep mode, RF Control Inactive	Hold for 6s	Jog*2	Flicker*2	Hold H button for 6s, jog twice to show the motor RF control is inactive; Hold H button for 2s, the RF control is active again
Direction Reverse	Hold for 10s	Jog*3	Flicker*3	All settings saved alter direction reversed
Reset	Hold for 16s	Jog*4	Flicker*4	All settings deleted

a.Pairing Motor with Controller

Way 1: Power on, add a new controller

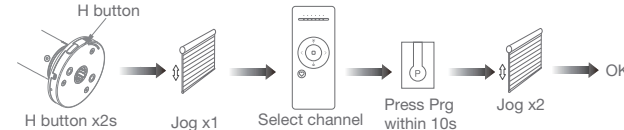

Way 2: Power on, add controller B via pre-existing controller A

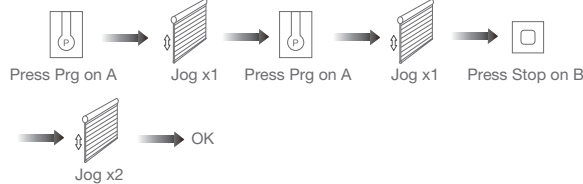

Note: Pairing can not be done under group channel or 0 channel.

b.Direction Reverse



If the limits are not set, and direction goes opposite.

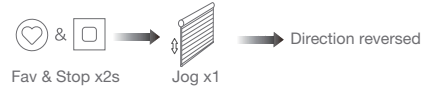

If limits are set and direction goes opposite.

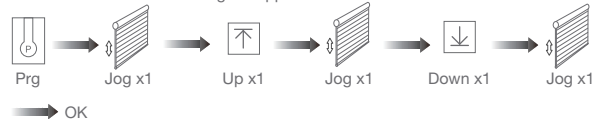

Note: Do reverse the direction when it goes opposite.

c.Upper&Lower Limits Setting

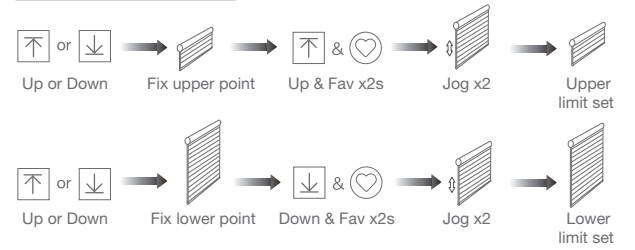

Note: Upper&Lower limits cannot be set at the same point.

Before limits set, the motor will run in one-touch mode by pressing Up or Down, hold Up or Down for 2s, motor runs in constant-touch mode.

Once limits set, press Up or Down, motor runs in constant-touch mode.

d.One-touch/Constant-touch Mode

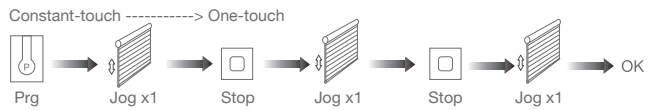

Same operation can toggle from one-touch to constant -touch mode.

Note: When motor in one-touch mode, hold Up or Down for more than 2s, it will run in constant-touch mode.

e.Setting and Cancelling Favorite Position

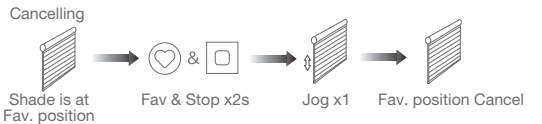
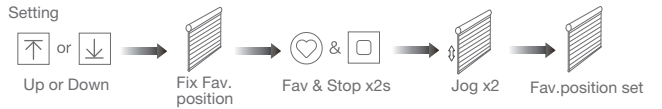

f.Hot key to the Fav. Position

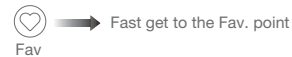

Note: The Fav.position setting only can be done after upper&lower limits set.

g.Adjusting Upper & Lower Limits

Adjust Upper limit

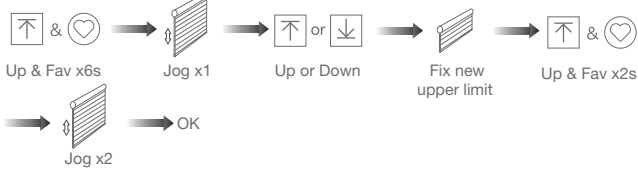

Adjust Lower limit

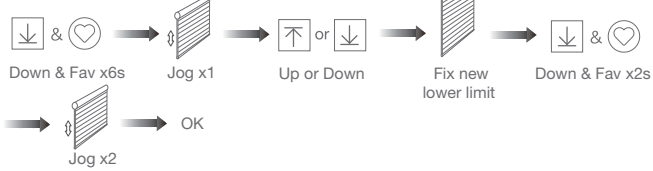

Note: The operation should be done within 4mins.

h.Adjusting Motor Speed

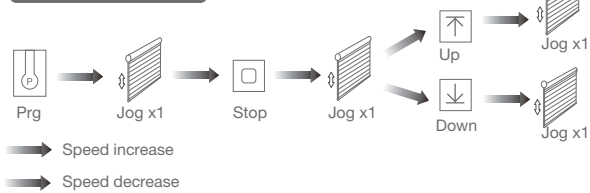

Note: If motor doesn't jog, the max/min speed has already been reached. There are 3 speeds adjustable.

i.Removing Controllers

Remove a single controller

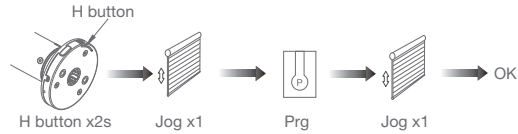

Remove controller B via pre-existing controller A

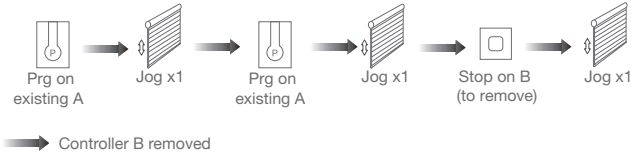

Remove all controllers

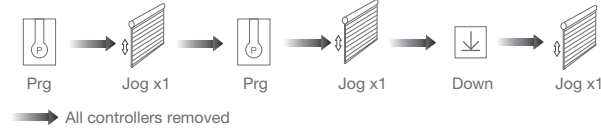

Note: All the settings are saved even controllers removed(limits set are saved). Controller A/B are already paired to motor.

j.Cancelling Limits

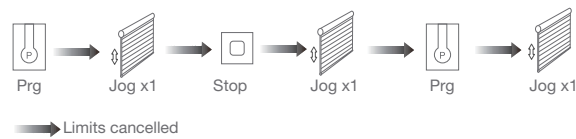

Note: It is forbidden to run the motor if installed into the shade without limits. Limits should be set immediately to protect the shade.

k.Check Motor Battery Level(for Bi-directional motor only)



Note: The shade running to the lower limit indicates that the battery power is 100%. The shade running to the upper limit indicates that the battery power is 0%. For example, if the shade is closed at 70%, it means the remaining battery power is 70%.

04 Troubleshooting

Fault	Cause	Solution
Motor does not work	1.Controller not paired 2.Motor inactive 3.Low battery	1.Add controller 2.Hold H button for 2s to activate motor 3.Charging
Motor stops suddenly	1.Upper & Lower limit set incorrectly 2.Shade exceed rated load 3.Low battery	1.Re-set Upper & Lower limits 2.Adjust load 3.Charging
LED flickers 8 times on motor head when motor starts	Low battery	Charging