

# 2" & 2 1/2" HORIZONTAL BLIND INSTALLATION INSTRUCTIONS

## TOOLS YOU WILL NEED:

Measuring Tape  
Level  
1/4" Magnetic Nut Driver  
Cordless Drill  
Screwdriver



## HARDWARE YOU WILL RECEIVE:

Installation Brackets  
Mounting Screws  
Valance Clips  
Small Screws

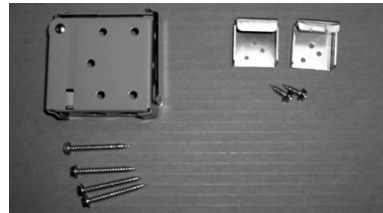

Contents may include the following, depending upon the mounting options you have chosen:

3/8" Spacer Block  
Support Bracket  
Metal Extension Bracket  
Valance Return Brackets & Corner Inserts  
Hold Down Brackets  
Cord Cleat

Hold the Installation Bracket in place. Set brackets to proper depth in the window sill and install the brackets. (Valance type will determine the depth of the bracket - CV or CVR). Insert the screws into the 1/4" magnetic nut driver and mount brackets to the wall. Use at least 2 of the 7 predrilled holes in the bracket.

Keeping Blind in "UP position". Insert the headrail into the bracket by sliding it in the open face of bracket. Close the flap to lock the blind securely into place.

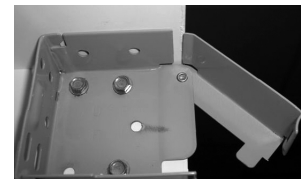
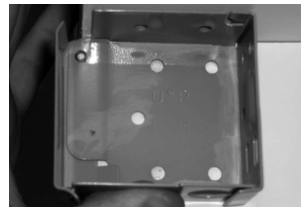

## VALANCE INSTALLATION

Locate marked pilot holes on the back of the valance. Attach Valance Clips with screws. Place valance on Headrail, tilt up and lower to lock into place.

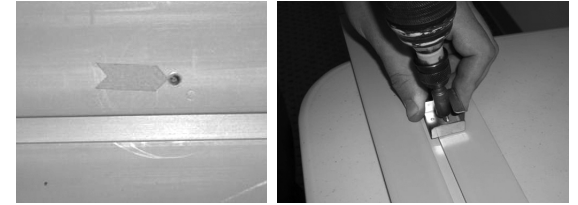

## ATTACHING VALANCE RETURNS (IF NEEDED)

Place valance return insert into slot in back of return. Then slide insert with the attached return into adjoining slot on the back of the valance.



## OPERATING YOUR NEW BLINDS

Each cord with individual tassels will tilt the slats in alternate directions.

The lift cord is used to raise and lower the blinds. Pull the cord away from the window to lift the blind and lock in position. Pull toward the center to release the blind from the locked position.

The slats must be open when raising or lowering the blind.

## CARE & CLEANING YOUR BLINDS

Tilt slats almost all the way in one direction. Dust may be easily brushed off using a feather duster or soft cloth. Turn the slats in the other direction and repeat. Never immerse your blinds in water.

