

Atlas Roman Shades Installation Instructions

Tools you will need:

Measuring Tape
1/4" Magnetic Nut Driver
Cordless Drill
Steamer



Hardware you will receive:

Installation Brackets
Mounting Screws
Wing Nuts
3/8" Spacer Block
Cord



Installing your shades:

Hold the installation Bracket in place, set bracket to proper depth in window (approximately 1/2") Install brackets. Insert the screws into the 1/4" magnetic nut driver and mount the brackets to the top of the window sill or wall.



- Secure returns on shade, using the double sided tape
- Remove wing nuts from installation brackets provided. Fasten loose fabric to both ends of the headrail.



Install shade by holding headrail up to window frame bolts should exit through the slots provided on each end of the headrail fasten with wing nuts.

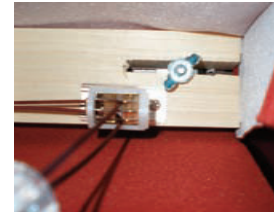

Operating your new shade:

The lift cord is used to raise and lower the shade. Pull the cord away from window to lift and lock and the blind in position. Pull toward the center to release from the locked position.

When finished, steam fabric or apply a crease away spray to release wrinkles from fabric that may appear as a result in packaging.



Care and cleaning

Romans shades are made of anti-static, dust and stain resistant fabrics, for most fabrics, the following options are available if your shade needs cleaning.

Dusting: Light dusting with a feather duster is all the cleaning that is needed in most circumstances.

Vacuuming: Use a hand held vacuum on lower setting for more thorough dust removal.

Spot Removal: Dampen a clean cloth with a warm water and mild soap solution. Dab soiled area with cloth, do not rub the fabric. Allow to dry completely in lowered position.

1.5 Inch (38mm) Headrail - Installation Instructions

- Mount the brackets** to the wall or window frame, with the outside brackets no further than 2 inches (50mm) from the ends of the headrail. On wide shades, space the additional bracket(s) at equal intervals.

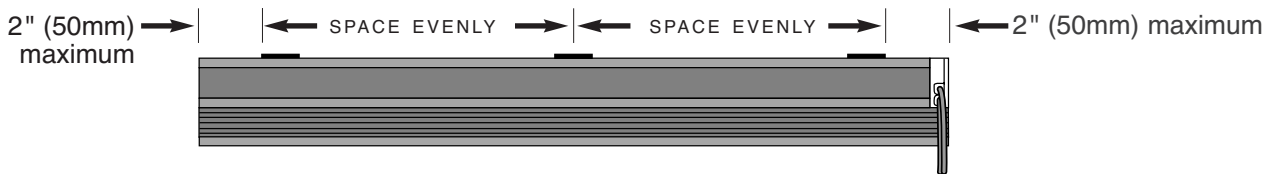

For **wall or outside mounts**, use the rear bracket holes.

Make sure the release tab is always mounted on the bottom.

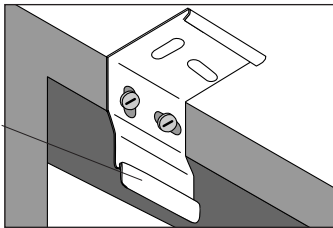

For **inside or ceiling mounts**, use the top bracket holes.

Make sure the release tab is always mounted on the bottom.

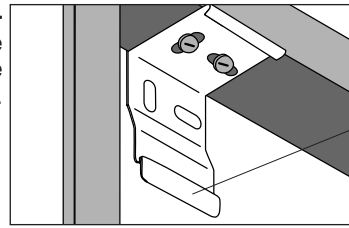

- Mount the headrail.** Position the headrail with the front panel (**A**) resting on the top lip of all brackets. Push the bottom front of the headrail firmly backwards and toward the window until the lip on the rear of the headrail engages the bracket and snaps into place, (**B**) as shown.

Push here backwards and toward the window.

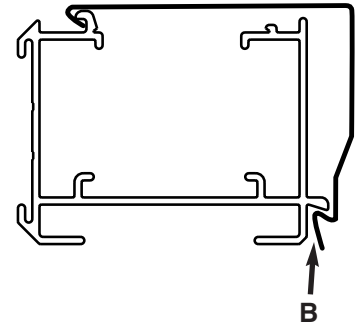
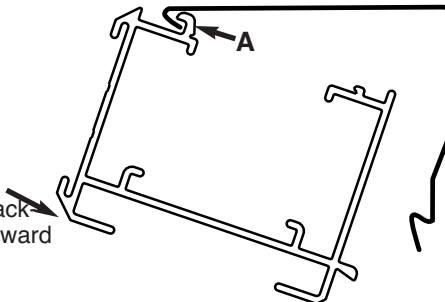

- Install the Tension Device.**

See details on next page

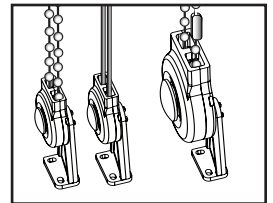

- Operate the shade** by pulling down on one side of the cord — one side of the cord raises the shade, the other side lowers the shade. Do not lift the bottom rail with your hands. Also, be careful not to place objects on the window sill that will interfere with operating the shade or cause it to hang unevenly.
- To remove a shade**, from the bottom rear of the headrail insert a flathead screwdriver in between the headrail and bracket. Gently twist the screwdriver and pry open the bracket to release the headrail. As you release the brackets, support the headrail to keep it from falling.

Instructions: Compliant Tension Device

1. MOUNT SHADE IN WINDOW shade should be mounted as usual.

2. CHOOSE TENSION DEVICE

“**Small**” for D-30, D-40 continuous polyester control cord loop, or continuous bead chain loop (no stops or connectors). “**Large**” for bead chain loop WITH connectors or stop balls

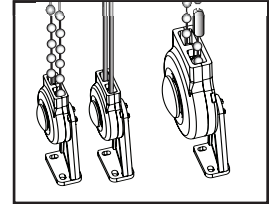

3. MATE TENSION DEVICE WITH CONTROL LOOP Press the center round button on the tension device which exposes the pulley on the opposite side. Hold the tension device by the outside cover. Wrap the loop around the pulley.

Release the center post which will trap the loop. Be sure the control cord/chain exits the channels at the narrow end as shown.

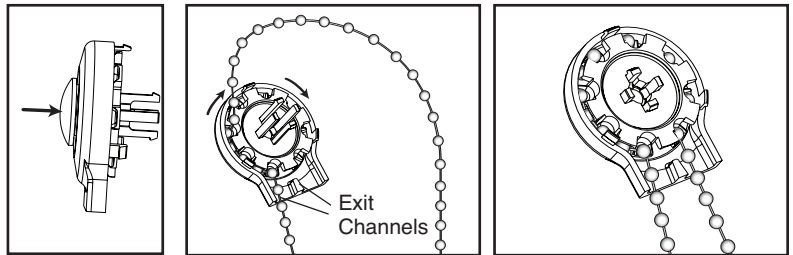

4. SNAP TOGETHER

Align the latches and slots of the front assembly and the back cover and snap together. Make sure the loop is not pinched by the two mating parts. Pull on cord/chain to test that the cord/bead chain does not move and is locked. Note the button must be out to lock loop.

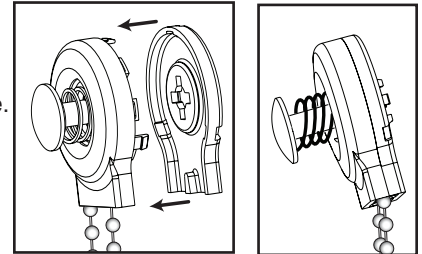

5. INSTALL MOUNTING BRACKET

Determine which direction the mounting bracket will face relative to the Tension Device. Make sure the Tension Device will be snapped into the mounting stand in the same correct direction. **Before** attaching Tension Device to the base, measure and mark the location in the window where the tension device will be mounted. Mount the base in position without the tension device attached. Position the Tension Device on the window frame or the wall so that the Tension Device and control cord/chain does not interfere with raising or lowering the shade. **The Tension Device should be installed so that cord/bead chain is taut without stretching or pulling down on it. Stretching the cord/bead chain will cause excessive wear. Do not twist or cross the control cord/bead chain.** Holding the Tension Device upright, and in position, as shown, insert and secure the two screws through holes in the mounting bracket. **The mounting screws must be secured into a solid surface or molly.**

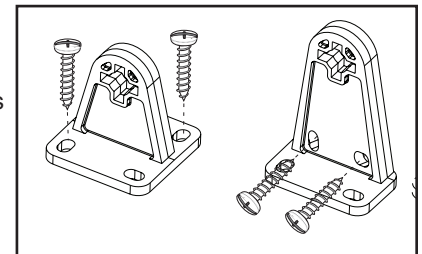

On inside mount shades the Tension Device may be mounted to the window sill, or side window frame or when the treatment spans beyond the window frame it may be mounted to the wall.

6. MATE TENSION DEVICE TO MOUNTING BRACKET

Once the tension device is snapped to the base it is designed not to be removed.

Press center round button exposing the four latching legs and press into the corresponding thru-hole of the mounting bracket stand until they latch snap and lock to the mounting stand. The loop should now pass freely through the Tension Device.

